

## Parts List:

1. Thumb Rivet
2. Silicone bands
3. Mic clip
4. Suspension hoop
5. Hoop screw
6. Spring washer
7. Retaining washer
8. Modular bar
9. Filler strip
10. Modular bracket
11. Star knob washer
12. Star knob
13. Pistol grip handle
14. Handle bolt
15. Handle plate
16. Handle lever
17. Boom adaptor
18. Boom adaptor bolt
19. boom adaptor washer
20. Boom adaptor lever

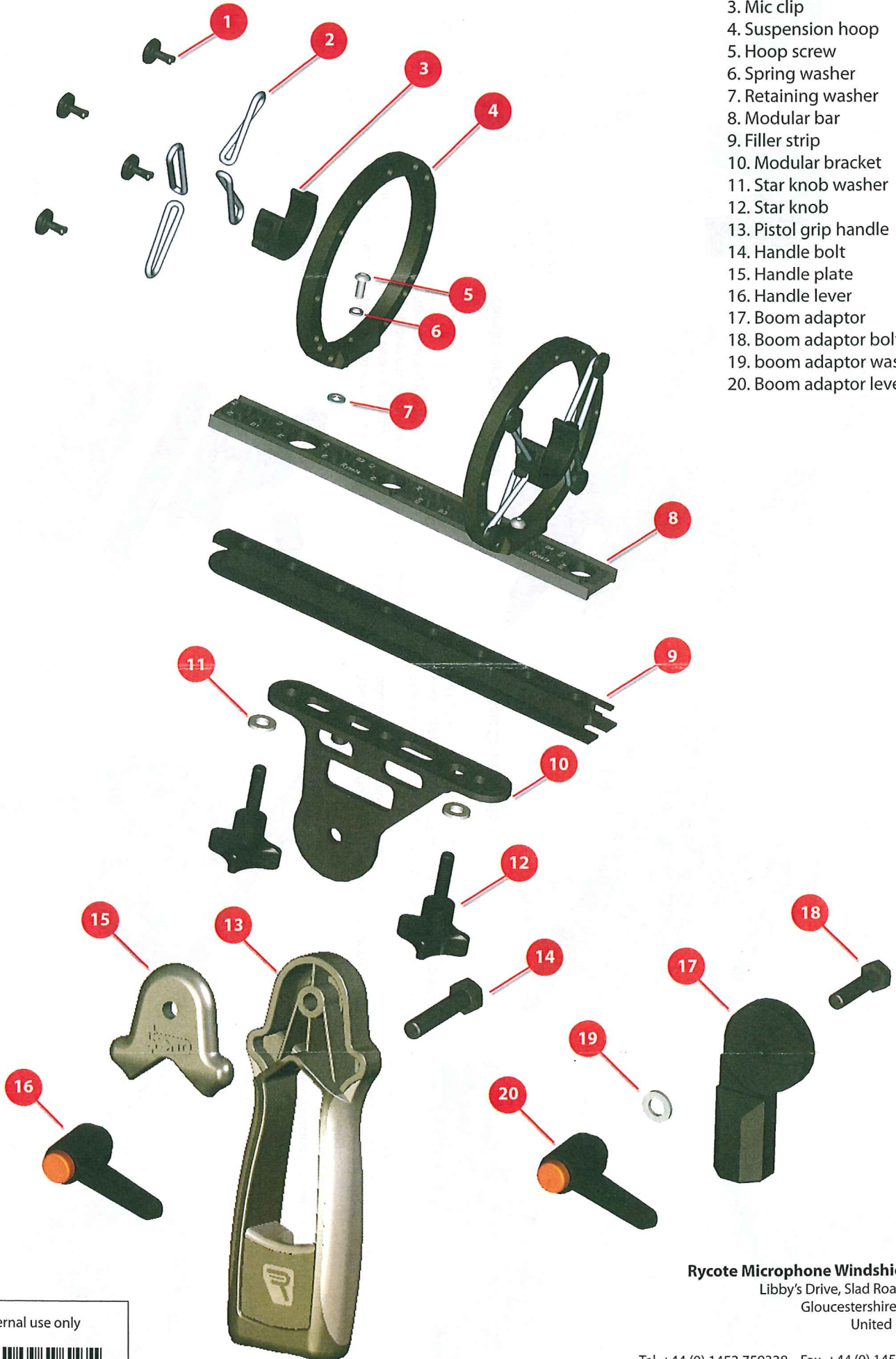

For internal use only



**Rycote Microphone Windshields Ltd**  
 Libby's Drive, Slad Road, Stroud  
 Gloucestershire GL5 1RN  
 United Kingdom

Tel. +44 (0) 1453 759338 Fax. +44 (0) 1453 764249  
 Email: [info@rycote.com](mailto:info@rycote.com)  
[www.rycote.com](http://www.rycote.com)

## Modular Suspension System

The best microphones are high precision devices - they are well-engineered and inherently quiet. Rycote recognises that microphone suspensions should have the same characteristics.

This Modular System mount will provide your microphone with superb isolation from mechanical shock and handling noise.

The Suspension has been designed and set up to be used immediately. Being a modular system it is possible to easily reconfigure the mount to suit different mounting positions.

### Adjustment of the Silicone Bands

To function correctly, the suspension system needs to control the movement of a microphone on all three axes.

To function correctly, the suspension system needs to control the movement of a microphone on all three axes. Rycote uses a 90° twist in the elastic elements to help achieve this.

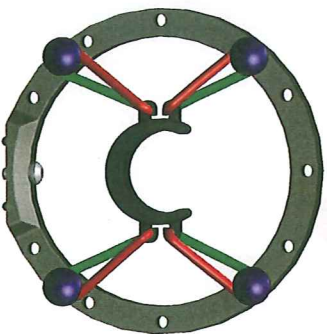

When you replace the silicone bands you should fit them this way round

2.4mm Bands



1.6mm Bands



Please note the new 'stepped' rivet on the Modular Hoop no longer requires the M3 Retaining Washer. "Thick," 2.4mm, bands should sit directly only the 'step' located just under the head of the rivet. "Thin," 1.6mm, bands should sit between the 'step' and the Modular Hoop. In both cases, the rivet should be flush with the back of the Modular Hoop, without any pinching of the band.

### Adjustment of Bar & Bracket

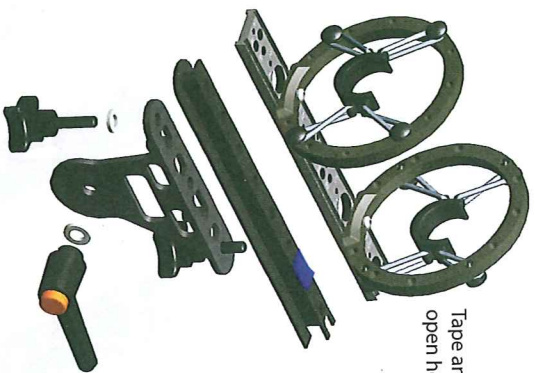

Tape any open holes

You can move the bracket and bar positions to alter the overall balance. If you move the bracket to a new position, tape over any open holes in the filler strip to prevent wind from entering the windshield.

### Cantilever Configuration



The "cantilever" configuration suits fast action recording and allows you to fit a foam gag.

Fit the thicker (2.4mm) silicone bands, move the hoops backwards and the bracket forwards to keep the balance correct.

### Adjustment of Hoops

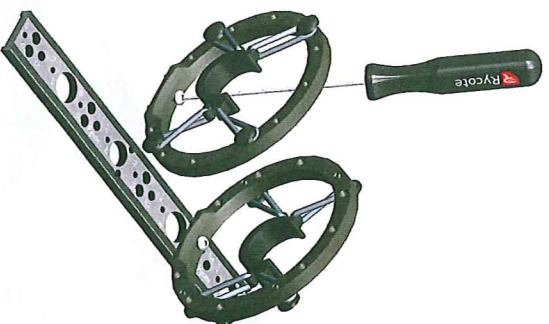

You can change the hoop positions - the hoops reverse for odd and even numbered locations.

The markings on the bar will enable you to note down your configuration. A1, A2, A3... refers to the hoop locations - B1, B2, B3... refers to the bracket positions.

### Classic Configuration



Rycote's Modular System is highly adaptable, allowing you more than one way to hold a microphone. Don't alter your technique to suit the mount - alter the mount to suit your technique.

The "Classic" configuration is the traditional soft-style mount which is how your suspension has been set up.

### Adjustment of Snap Rivets

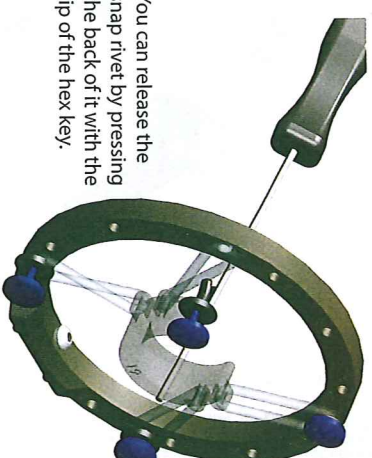

You can release the snap rivet by pressing the back of it with the tip of the hex key.

There is no need to pull the central pin right out of the rivet.

When replacing the snap rivet, push the body into the hole in the hoop before pressing the pin fully home, which will splay the "wings".

The broad head of the snap rivet must always be on the labelled face of the hoop.

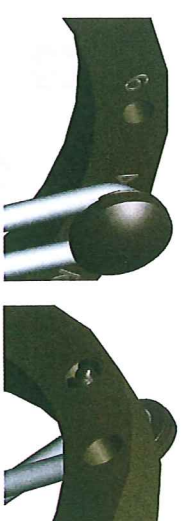

### Conbox

The most common transmission path and source of noise is the microphone cable and Rycote has developed the Conbox to eradicate this.



The Conbox is available from your Rycote dealer as a Modular System accessory.